



**detroit  
shoreway**

## LAKE AVENUE

A THRIVING, VIBRANT, DIVERSE  
AND WALKABLE NEIGHBORHOOD

CLEVELAND PLANNING COMMISSION  
CONCEPTUAL MASTER PLAN  
11 15 2019

DETROIT SHOREWAY CDO  
BIALOSKY CLEVELAND



An aerial, black and white photograph of a city street. A prominent, multi-story building with two rounded towers is situated on the right side of the street. In front of the building is a large, paved parking lot with several cars parked. The street curves to the left in the foreground. To the left of the street is a dense area of trees. In the background, a railway track runs parallel to the street. The word "OVERVIEW" is superimposed in large, white, italicized capital letters across the center of the image.

# *OVERVIEW*







# PROJECT STEERING COMMITTEE

## COMMUNITY LEADERSHIP:

- **Anne Armstrong & Michael Armstrong**, Residents, Edgewater Parke Block Club
- **Dan Bush**, Owner, 78th Street Studios
- **Kelly Coffman**, Senior Strategic Park Planner, Cleveland MetroParks
- **Anita Gerrasch**, Administrator, St. Augustine Health Ministries
- **Nikki Hudson**, Resident, Edgewater Parke Block Club
- **Gary McNamara**, Owner, McNamara's
- **Bobbi Reichtell**, Resident, Friend of Lake Ave Bridge
- **Kraig Sternquist**, General Manager, Don's Lighthouse
- **Morgan Taggart**, Resident, Edgewater Parke Block Club
- **Julia Van Wagenen**, Resident, Edgewater Parke Block Club
- **Nick Catanzarite, Jesse Grant** (Resident), & **Aaron Taylor**, JRoc Development

## STAFF LEADERSHIP:

- **Matt Zone**, Ward 15 Councilman
- **Jenny Spencer**, Managing Director, DSCDO/Cudell Inc
- **Phil Kidd**, Special Projects Manager, DSCDO
- **Christopher Brown**, Safety & Community Outreach, Cudell Inc.
- **Ted Ferringer**, Architect, Bialosky Cleveland
- **Adam Davenport**, District Planner, City of Cleveland







# PROJECT GOALS

1. IMPROVE SAFETY FOR NON-VEHICULAR USERS ALONG LAKE AVE
2. IDENTIFY OPPORTUNITIES FOR AESTHETIC IMPROVEMENTS
3. PROVIDE A COMMUNITY VISION FOR EQUITABLE AND INCLUSIVE  
FUTURE LAND-USE & DEVELOPMENT
4. RE-ENVISION THE CORRIDOR'S IDENTITY
5. CREATE A ROADMAP TO PURSUE FUNDING





# *STAKEHOLDER ENGAGEMENT*



# PUBLIC INPUT SUMMARY

## 1. TWO PUBLIC MEETINGS

- HOSTED AT W78TH STREET STUDIOS
- 113 TOTAL ATTENDEES
- 215+ IDEAS & COMMENTS VIA SWOT ANALYSIS STATIONS

## 2. FOUR STEERING COMMITTEE MEETINGS

- 19 MEMBERS + INVITED TOPIC EXPERT GUESTS

## 3. ADDITIONAL OUTREACH MEETINGS & ENGAGEMENT

- ST. LUKE'S EPISCOPAL COMMUNITY DINNER PRESENTATION - 24 SURVEY INTERVIEWS
- ONLINE ENGAGEMENT AT CLEVELAND.MINDMIXER.COM - 35 USER RESPONSES
- 3 DAYS OF OUTREACH AT CPL WALZ LIBRARY BRANCH



# STRENGTHS

(+)

51 TOTAL IDEAS &  
COMMENTS

73 TOTAL IDEAS  
& COMMENTS

(+)

OPPORTUNITIES

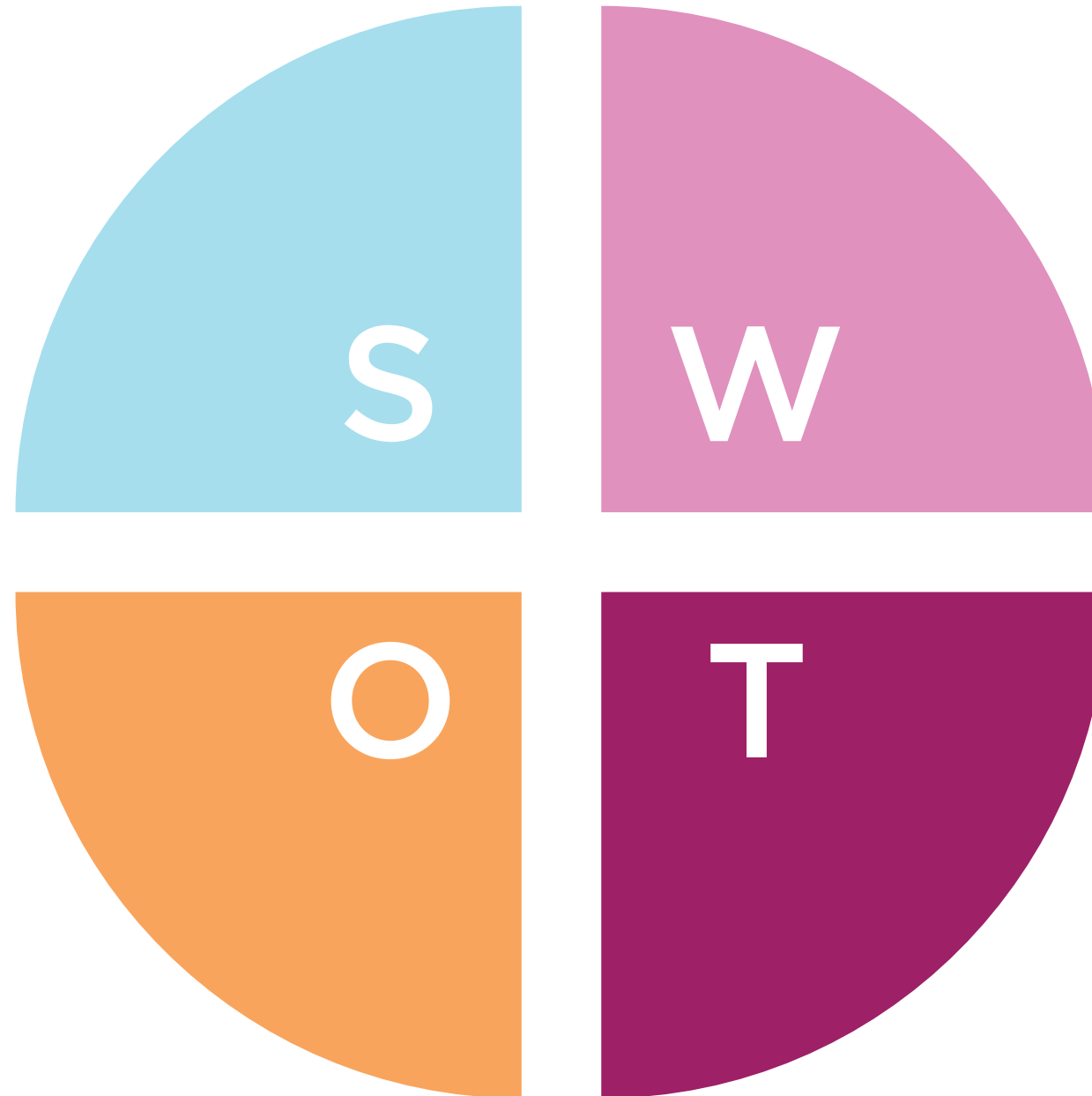

# WEAKNESSES

(-)

66 TOTAL IDEAS &  
COMMENTS

25 TOTAL IDEAS &  
COMMENTS

(-)

THREATS



An aerial, black and white photograph of a city street. The street runs vertically through the center. On the left side, there are several large, multi-story buildings, including a prominent one with a grid of windows. A smaller building with a distinctive octagonal glass structure is visible. On the right side, there are more residential-style buildings and a large parking lot. In the foreground of the parking lot, a Burger King restaurant is clearly visible with its logo sign. The overall scene depicts a dense urban environment.

***DESIGN  
RECOMMENDATIONS***



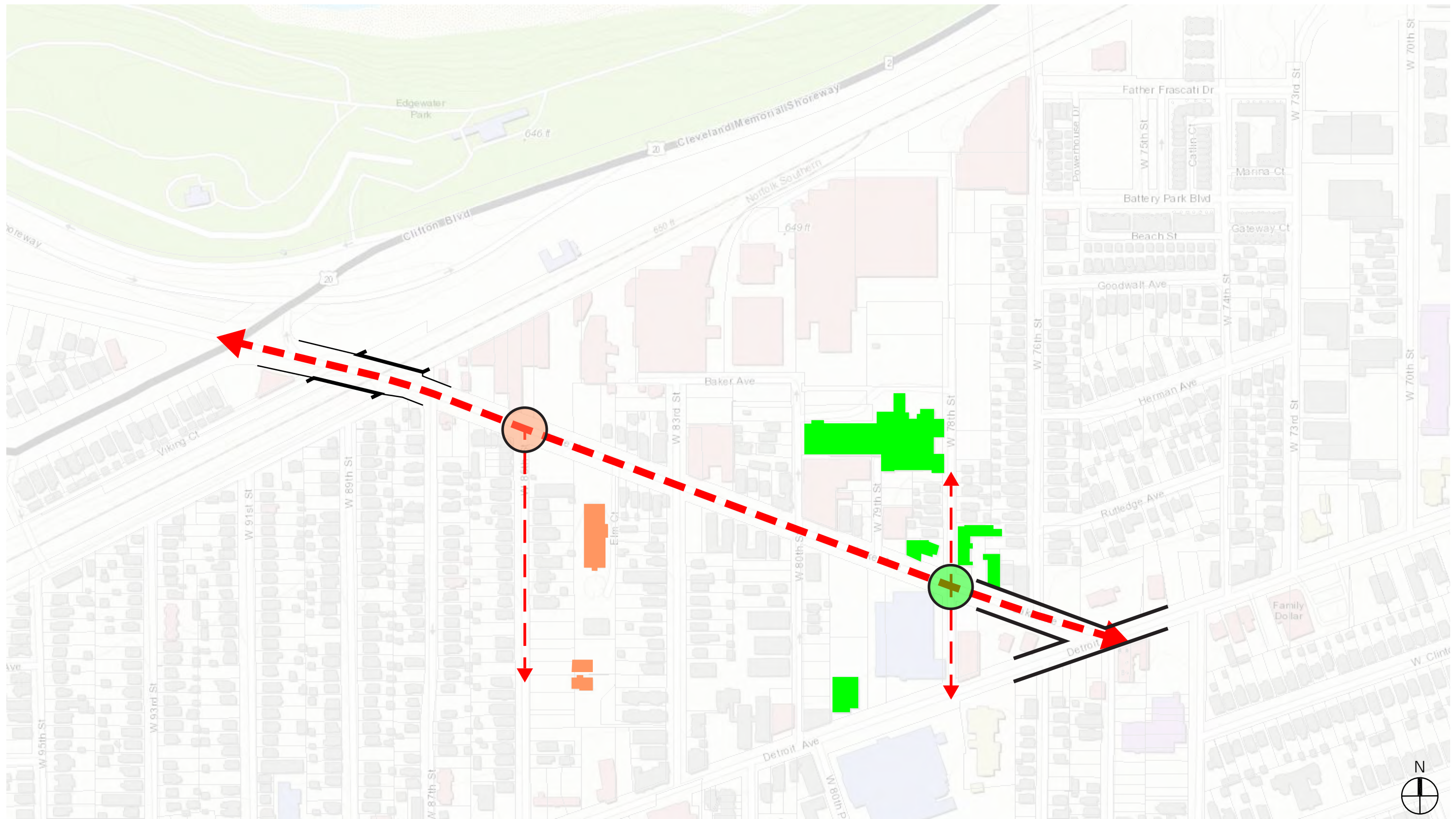



## 5. STRIEBINGER (NORFOLK-SOUTHERN)

### BRIDGE to CLIFTON BLVD

- A. STABILIZE BRIDGE & ADDRESS STORM WATER ISSUES
- B. CREATE GATEWAY LINKING EDGEWATER & GORDON SQUARE ARTS DISTRICT
- C. HISTORIC RESTORATION OF BRIDGE
- D. IMPROVE PEDESTRIAN & BICYCLIST SAFETY
- E. NARROW EFFECTIVE WIDTH OF STREET

## 3. LAKE AVE & W78TH STREET

- A. PROVIDE PEDESTRIAN CROSSING
- B. CALM TRAFFIC
- C. IMPROVE CONNECTION & PRESENCE OF ST. LUKE'S, W78TH STUDIOS, & WALZ LIBRARY

## 2. LAKE & DETROIT

- A. CALM TRAFFIC
- B. IMPROVE PEDESTRIAN & BICYCLIST SAFETY
- C. STRENGTHEN TRANSITION FROM DETROIT AVE TO LAKE AVE

## 4. LAKE AVE & W85TH STREET

- A. PROVIDE PEDESTRIAN CROSSING
- B. CALM TRAFFIC
- C. IMPROVE CONNECTION & PRESENCE OF LAKE PARK

## 1. LAKE AVE

- A. CALM TRAFFIC
- B. IMPROVE PEDESTRIAN & BICYCLIST SAFETY
- C. IMPROVE STREETScape EXPERIENCE

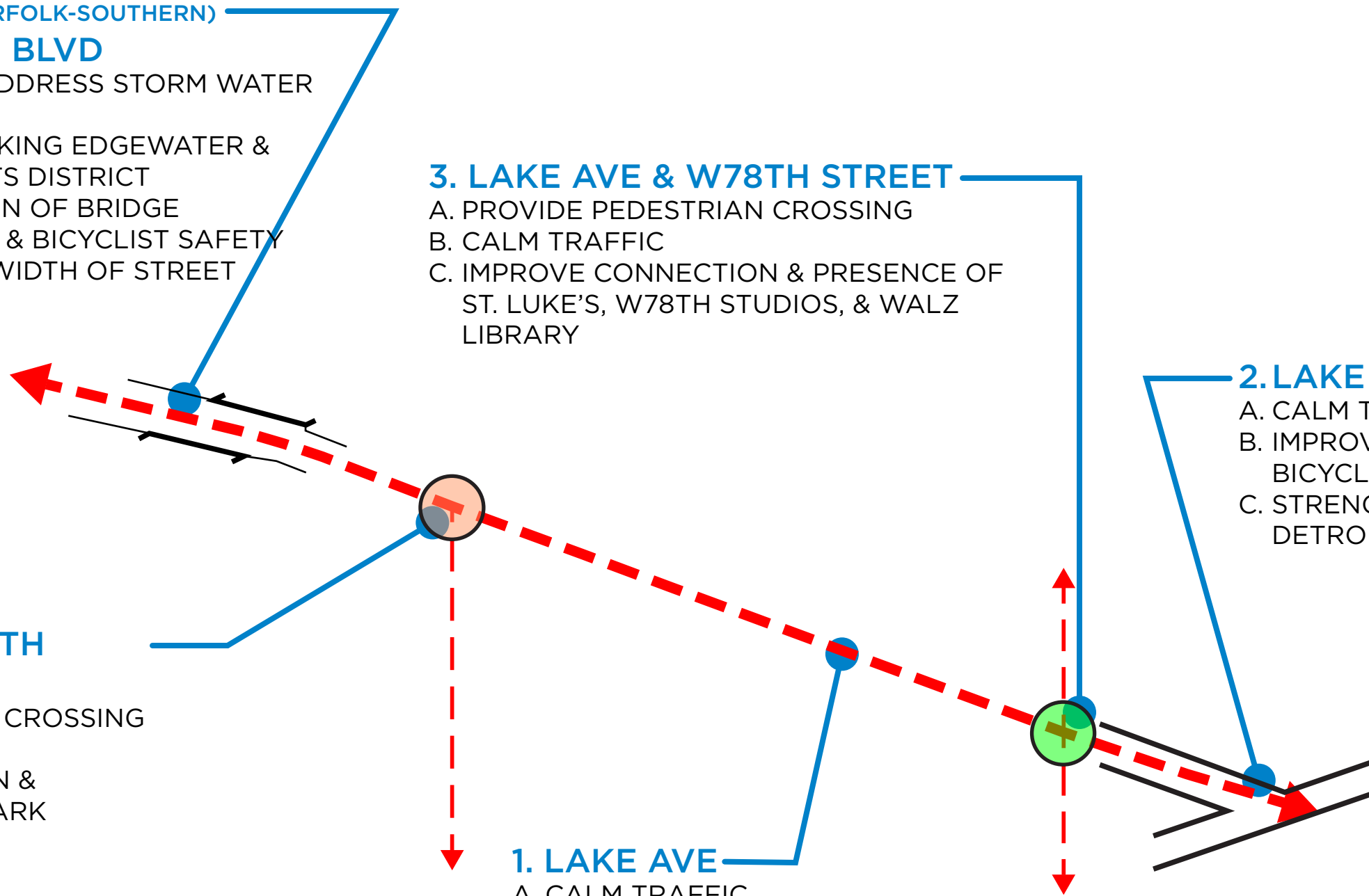





**1. TYPICAL MID-BLOCK  
STREET CONDITION**



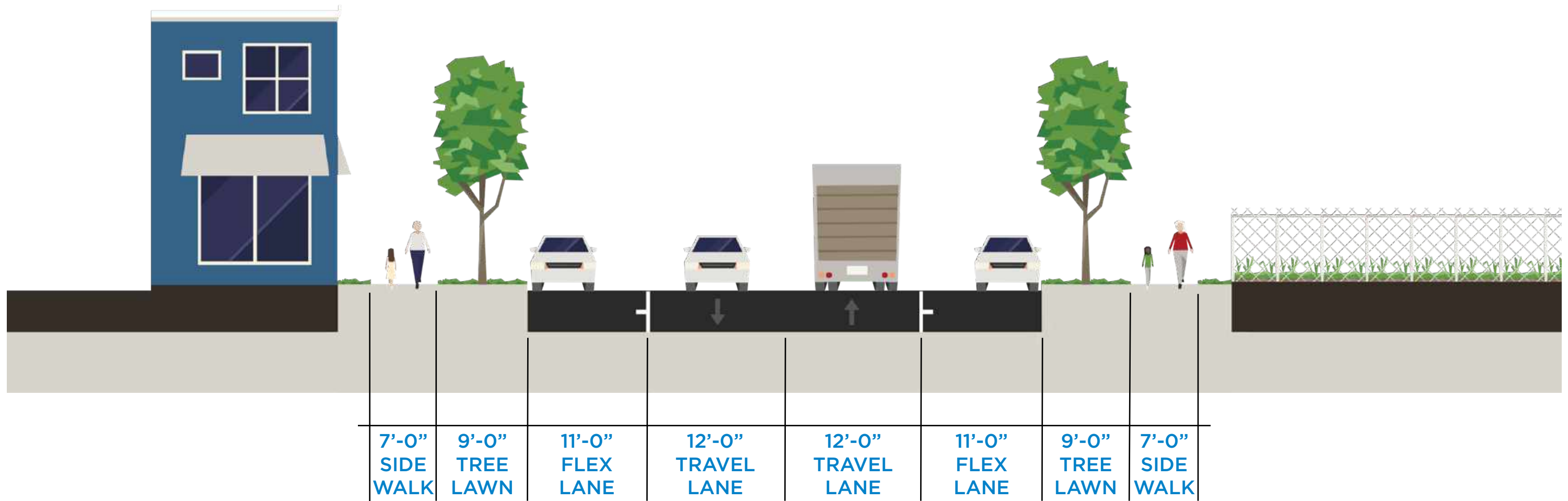

PUBLIC RIGHT-OF-WAY  
78'-0"

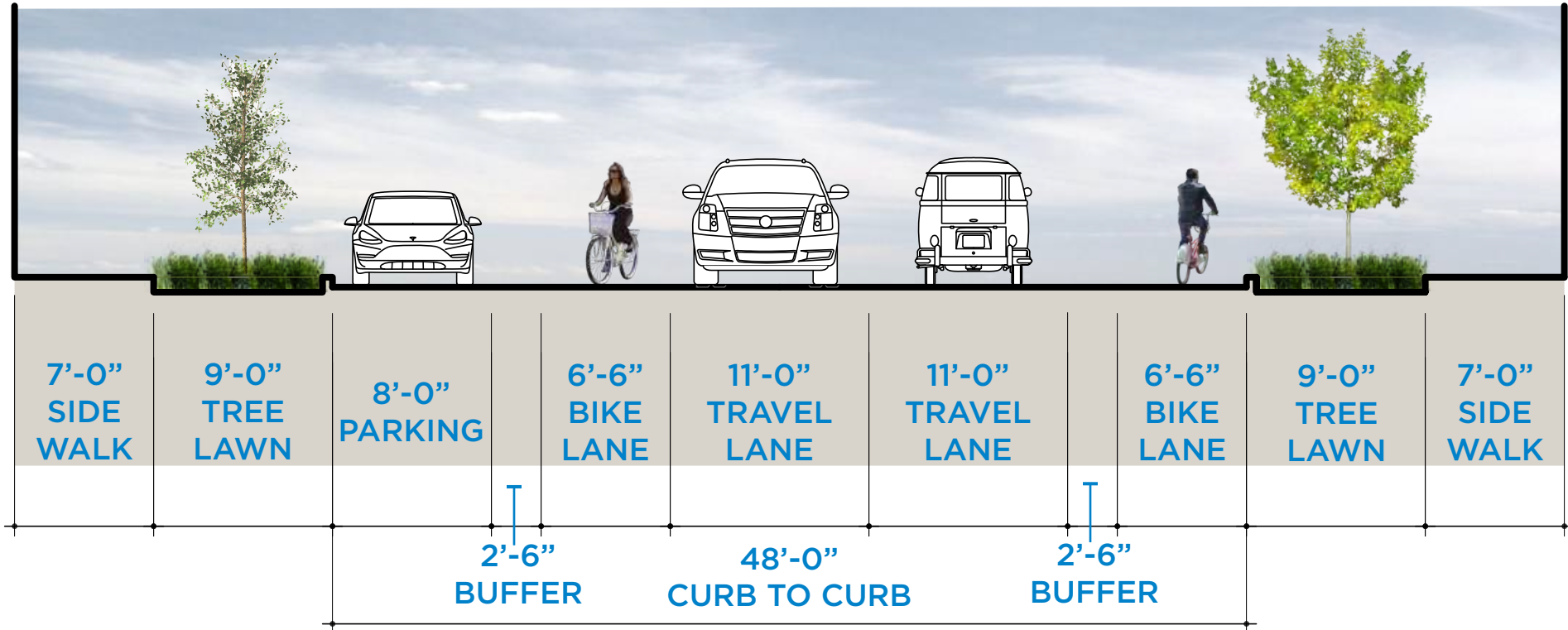
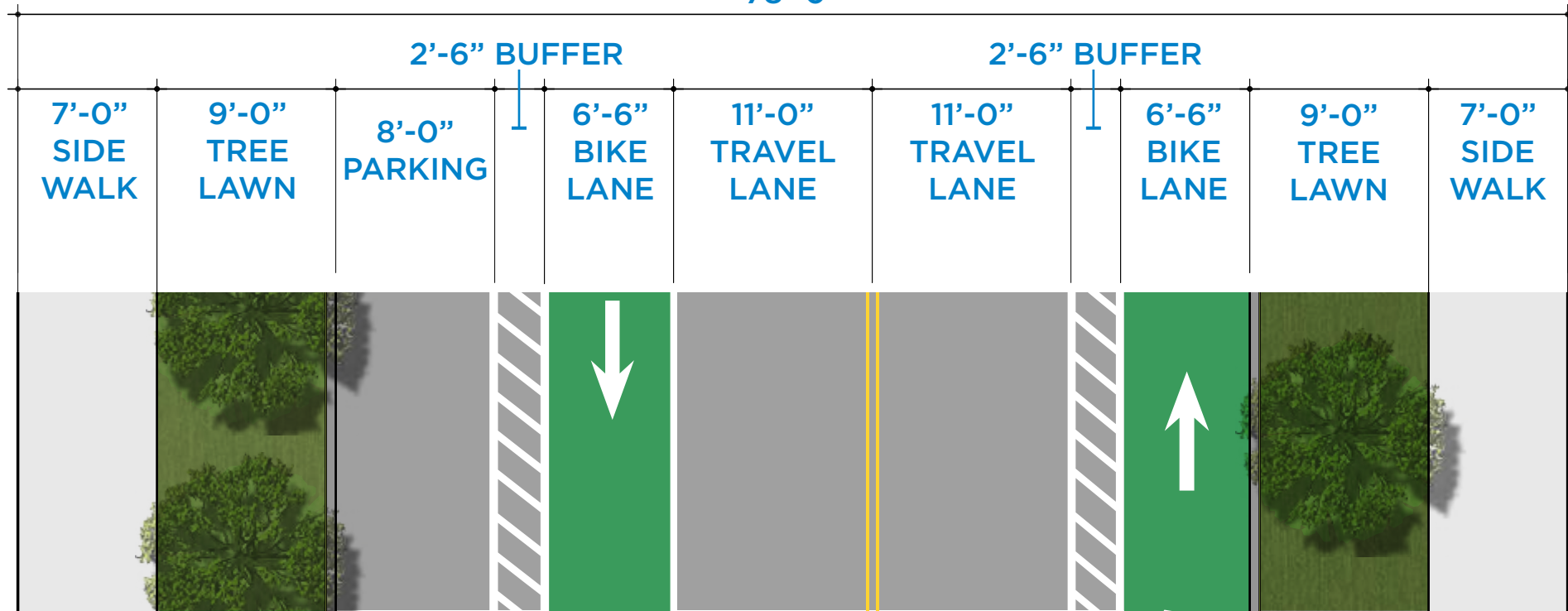



A black and white photograph of a street intersection. In the foreground, a utility pole stands on the right side of the frame, with a large, dark, rectangular utility box attached to it. A sidewalk runs along the right side of the road. In the middle ground, a silver minivan is driving on the road. To the left, there is a gas station with a sign that says "EXPRESS GAS" and a price of "299". In the background, there are several buildings, including a tall, dark brick building. A large, circular sign with the text "Thanks Detroit" is visible on the right side of the road. The sky is overcast.

# 2. LAKE & DETROIT INTERSECTION

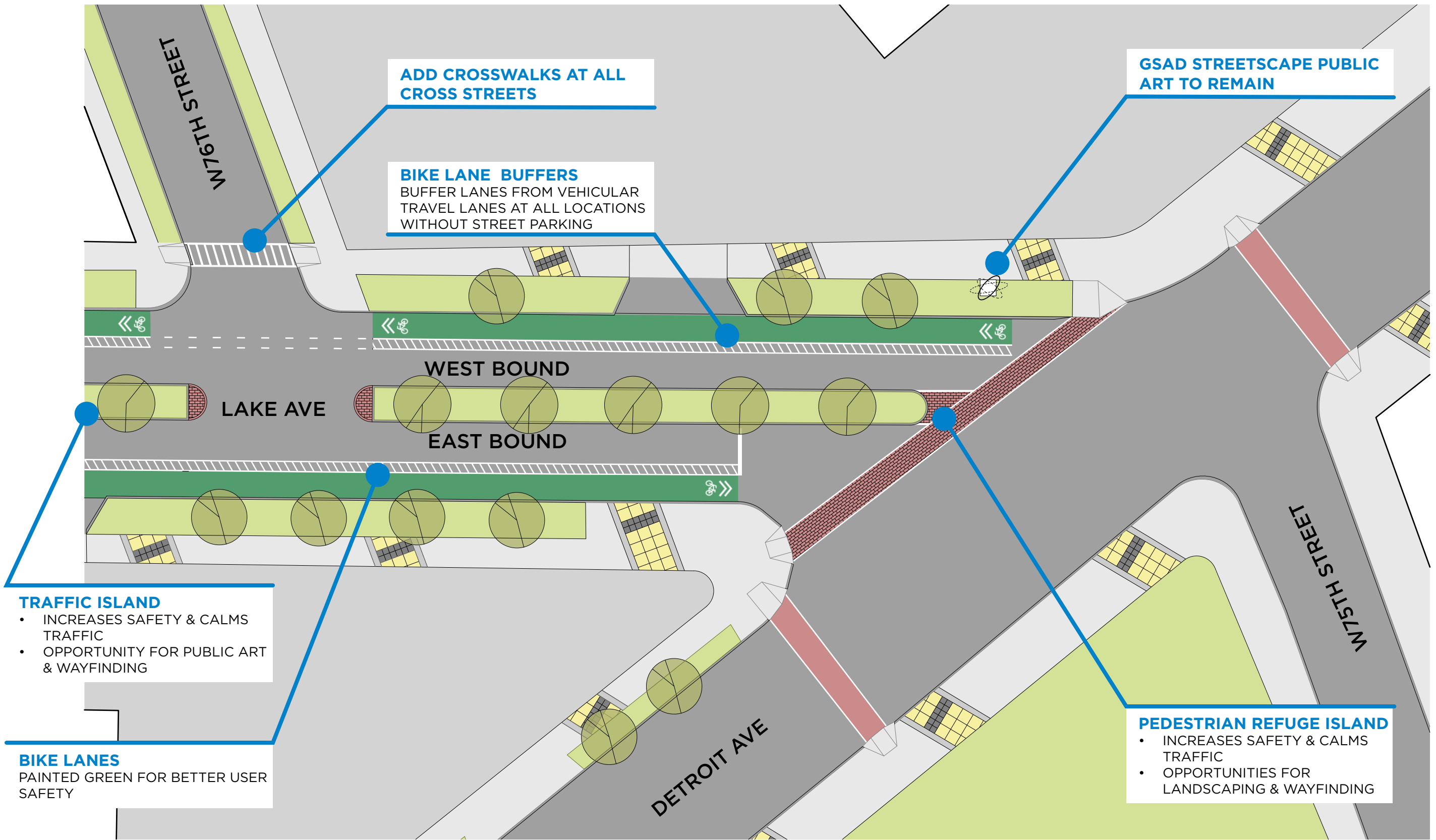

**ADD CROSSWALKS AT ALL CROSS STREETS**

**BIKE LANE BUFFERS**  
 BUFFER LANES FROM VEHICULAR TRAVEL LANES AT ALL LOCATIONS WITHOUT STREET PARKING

**GSAD STREETSCAPE PUBLIC ART TO REMAIN**

**TRAFFIC ISLAND**

- INCREASES SAFETY & CALMS TRAFFIC
- OPPORTUNITY FOR PUBLIC ART & WAYFINDING

**BIKE LANES**  
 PAINTED GREEN FOR BETTER USER SAFETY

**PEDESTRIAN REFUGE ISLAND**

- INCREASES SAFETY & CALMS TRAFFIC
- OPPORTUNITIES FOR LANDSCAPING & WAYFINDING



A black and white photograph of a street intersection. The street is paved with asphalt and has white crosswalk lines. On the right side, there is a white picket fence in front of a white church with a steeple. A sign on the church says "Join Us" and "God is in the City". A utility pole with many wires is in the foreground. In the background, there are industrial buildings and more utility poles. The text "2. LAKE & W78TH INTERSECTION" is overlaid in large, white, bold, italicized letters across the center of the image.

**2. LAKE & W78TH  
INTERSECTION**







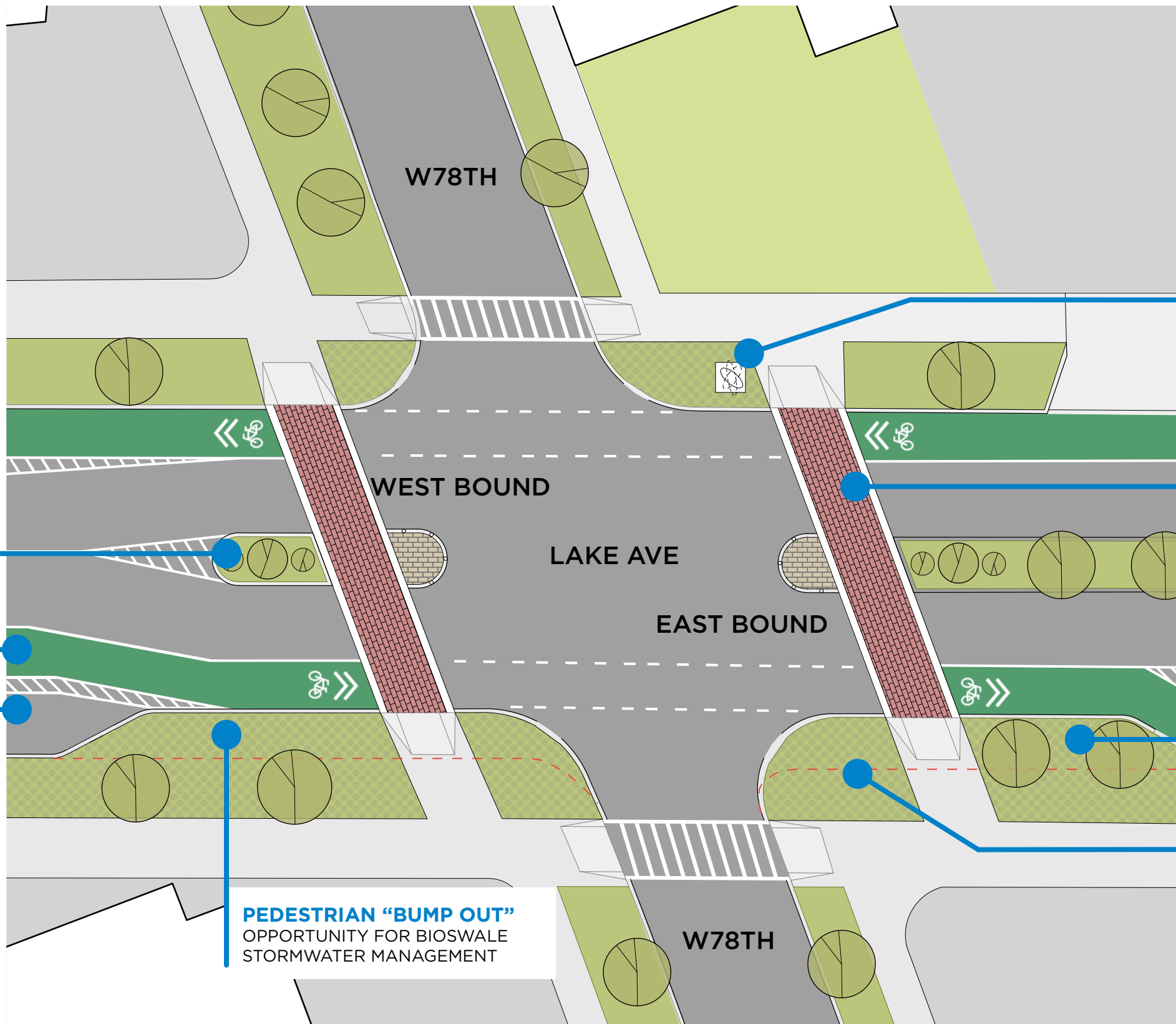

**GSAD STREETScape PUBLIC ART TO REMAIN**

**DECORATIVE CROSSWALKS**  
SIMILAR TO DETROIT AVE & WEST SHOREWAY CROSSWALKS

**PEDESTRIAN "BUMP OUT"**  
OPPORTUNITY FOR BIOSWALE STORMWATER MANAGEMENT

**EXISTING CURB CUT**

**PEDESTRIAN "BUMP OUT"**  
OPPORTUNITY FOR BIOSWALE STORMWATER MANAGEMENT

**PEDESTRIAN REFUGE ISLAND**

- INCREASES SAFETY & CALMS TRAFFIC
- OPPORTUNITIES FOR LANDSCAPING & WAYFINDING

**BIKE LANES**

PAINTED GREEN FOR BETTER USER SAFETY

**STREET PARKING**

BUFFERED FROM BIKE LANES

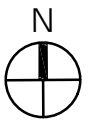













**3. LAKE & W85TH  
INTERSECTION**



**DECORATIVE CROSSWALKS**  
SIMILAR TO DETROIT AVE & WEST SHOREWAY CROSSWALKS

**PEDESTRIAN REFUGE ISLAND**

- INCREASES SAFETY & CALMS TRAFFIC
- OPPORTUNITIES FOR LANDSCAPING & WAYFINDING

**BIKE LANES**  
PAINTED GREEN FOR BETTER USER SAFETY

**STREET PARKING**  
BUFFERED FROM BIKE LANES

**PEDESTRIAN "BUMP OUT"**  
OPPORTUNITY FOR BIOSWALE STORMWATER MANAGEMENT

**NEW TREE LAWNS & LANDSCAPING**  
CONTINUOUS EACH SIDE OF STREET

**TRAFFIC ISLAND**

- INCREASES SAFETY & CALMS TRAFFIC
- OPPORTUNITY FOR PUBLIC ART & WAYFINDING

**PEDESTRIAN "BUMP OUT"**  
OPPORTUNITY FOR BIOSWALE STORMWATER MANAGEMENT

**EXISTING CURB CUT**

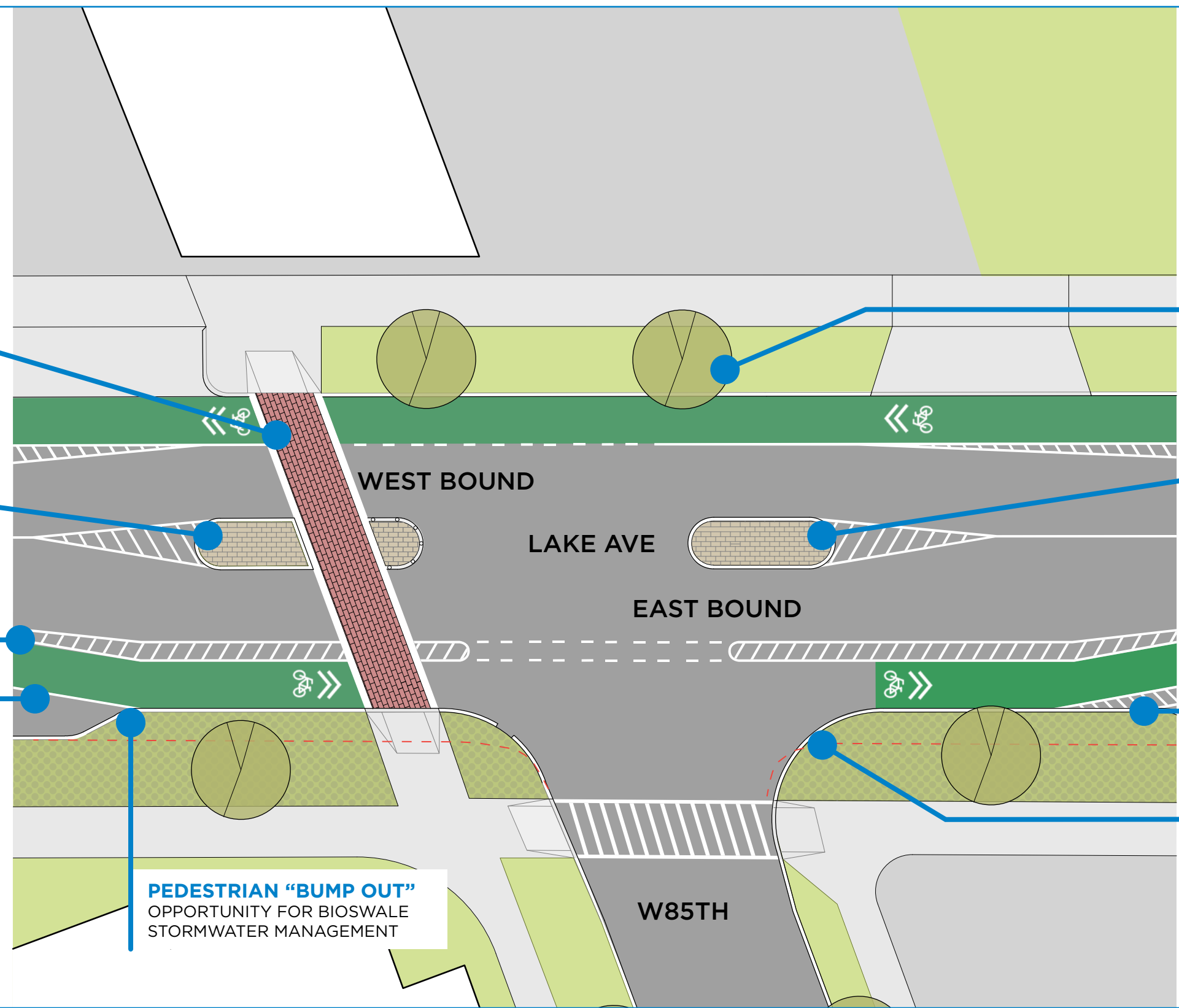



**4. THE STRIEBINGER BRIDGE  
TO  
CLIFTON BLVD**







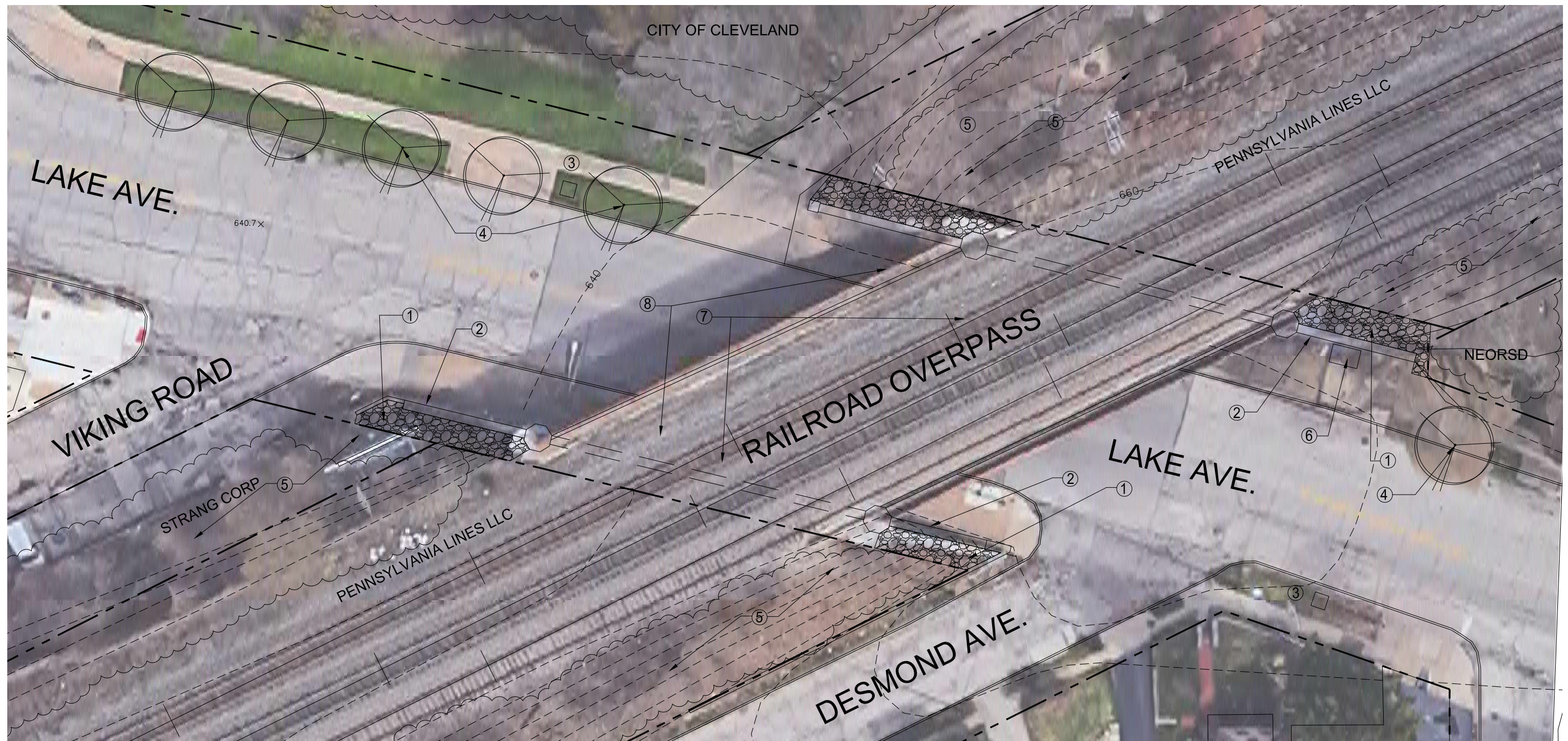

**CONCEPT FOR PROPOSED IMPROVEMENTS:**

IMPLEMENT SITE IMPROVEMENTS AND RESTORE STANDARDS THAT ARE CONSISTENT WITH NEARBY NEIGHBORHOOD TRANSITIONS:

- SAFETY
- BEAUTIFICATION
- NEIGHBORHOOD IDENTITY

**PROPOSED ACTION ITEMS:**

- ① Remove vegetation and rubble from hillsides. Backfill excavated areas behind abutments with glaciated boulders and topsoil for pockets of native grasses and perennials.
- ② Patch and paint concrete bridge abutments.
- ③ Add feature/signage to provide identities of Edgewater and Gordon Square communities respective sides of overpass.
- ④ Add street trees along north side of Lake Ave.
- ⑤ With private funding & community action, extend hillside site improvements beyond right-of-way areas.
- ⑥ Remove abandoned structure.
- ⑦ Add lighting under overpass per Engineering & Construction.
- ⑧ Replace damaged sidewalk under overpass per Engineering & Construction.







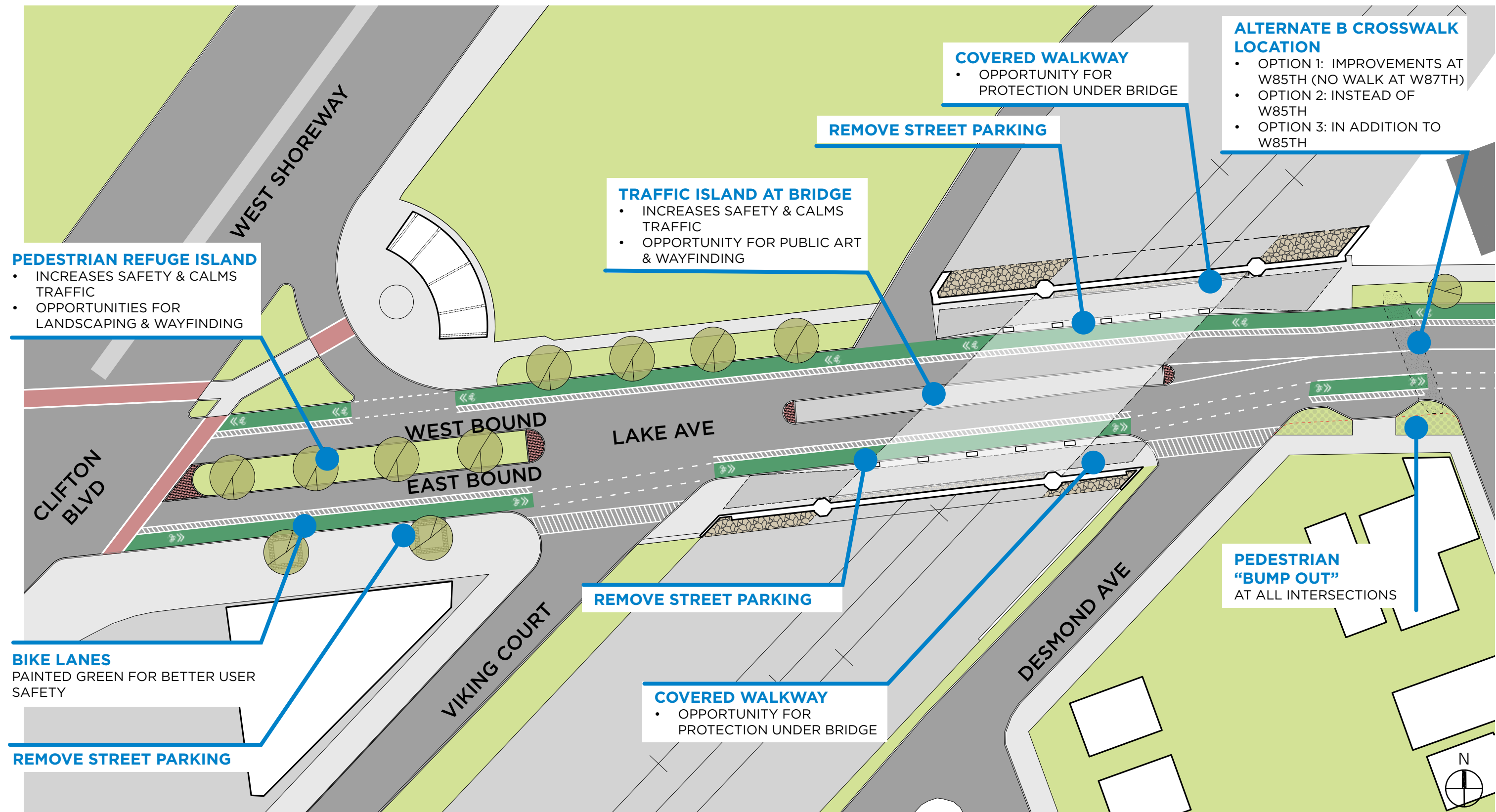

**ALTERNATE B CROSSWALK LOCATION**

- OPTION 1: IMPROVEMENTS AT W85TH (NO WALK AT W87TH)
- OPTION 2: INSTEAD OF W85TH
- OPTION 3: IN ADDITION TO W85TH

**COVERED WALKWAY**

- OPPORTUNITY FOR PROTECTION UNDER BRIDGE

**REMOVE STREET PARKING**

**TRAFFIC ISLAND AT BRIDGE**

- INCREASES SAFETY & CALMS TRAFFIC
- OPPORTUNITY FOR PUBLIC ART & WAYFINDING

**PEDESTRIAN REFUGE ISLAND**

- INCREASES SAFETY & CALMS TRAFFIC
- OPPORTUNITIES FOR LANDSCAPING & WAYFINDING

**PEDESTRIAN "BUMP OUT"**

AT ALL INTERSECTIONS

**COVERED WALKWAY**

- OPPORTUNITY FOR PROTECTION UNDER BRIDGE

**REMOVE STREET PARKING**

**BIKE LANES**

PAINTED GREEN FOR BETTER USER SAFETY

**REMOVE STREET PARKING**













1911

ENJOY

*FIN.*

1911  
ENJOY  
1911